

STRAW WATTLE

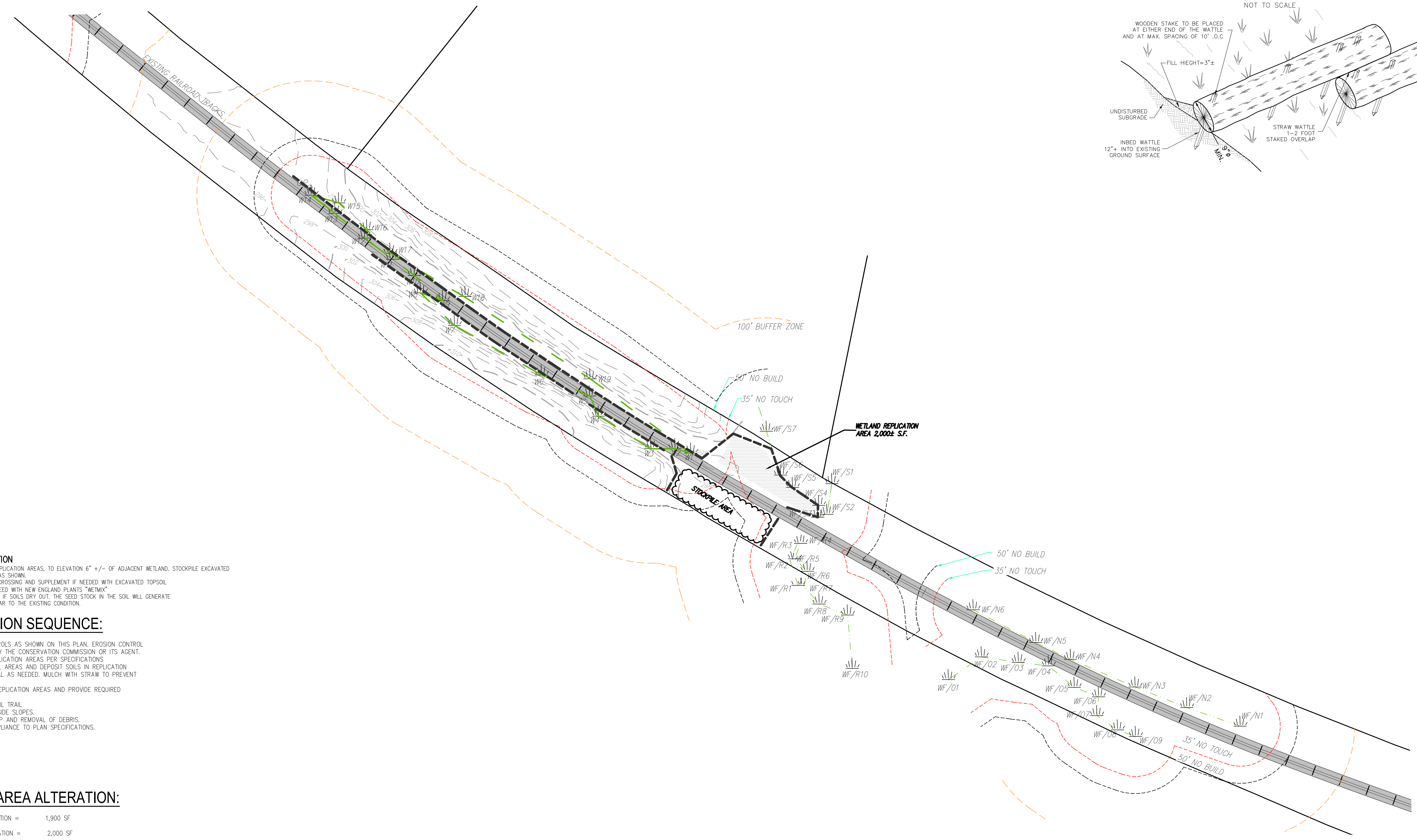
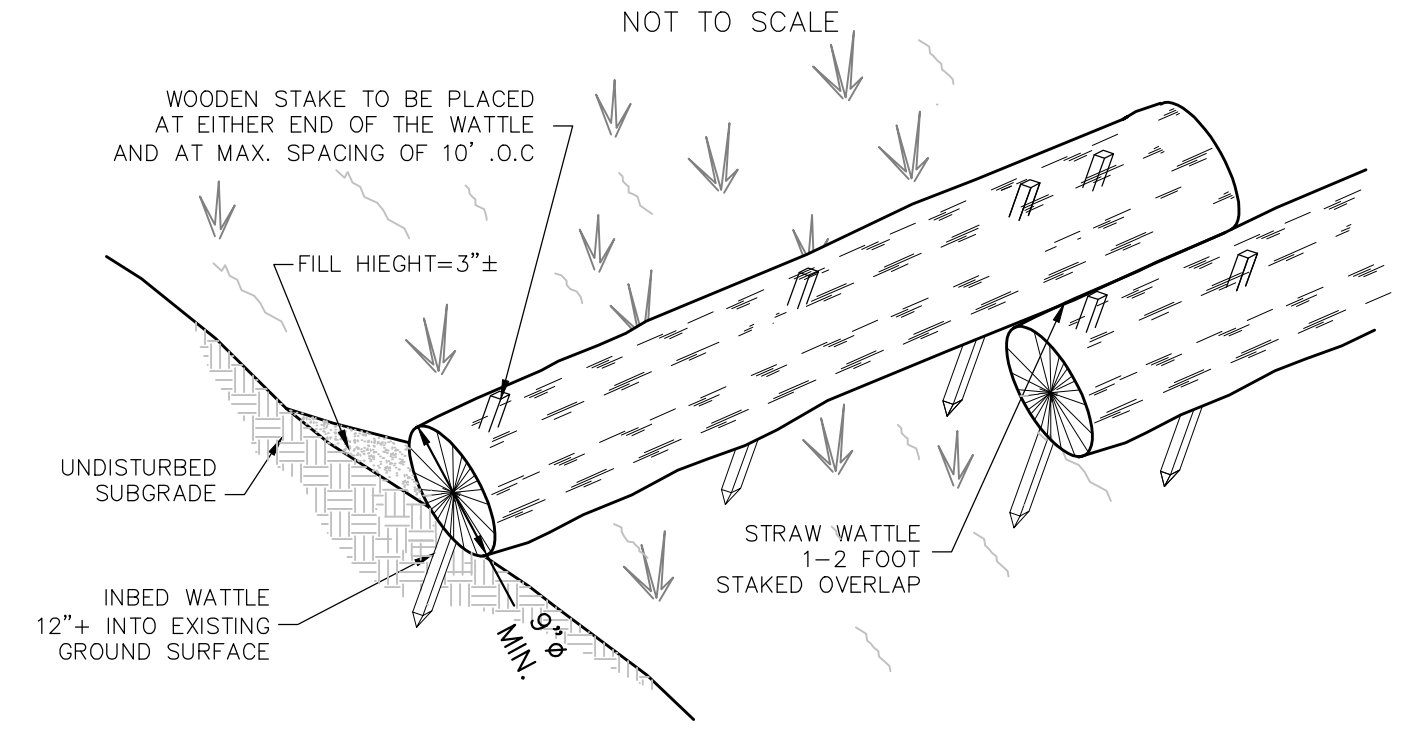

NOTES:

- D. WETLAND REPLICATION**
- EXCAVATE SOILS FROM REPLICATION AREAS, TO ELEVATION 6" +/- OF ADJACENT WETLAND. STOCKPILE EXCAVATED SOILS IN STOCKPILE AREA AS SHOWN
 - REPLACE WITH SOIL FROM CROSSING AND SUPPLEMENT IF NEEDED WITH EXCAVATED TOPSOIL. MATCH ADJACENT GRADE SEED WITH NEW ENGLAND PLANTS "WETMIX"
 - MULCH AND KEEP WATERED IF SOILS DRY OUT. THE SEED STOCK IN THE SOIL WILL GENERATE WETLAND VEGETATION SIMILAR TO THE EXISTING CONDITION.

CONSTRUCTION SEQUENCE:

- INSTALL EROSION CONTROLS AS SHOWN ON THIS PLAN. EROSION CONTROL SHALL BE INSPECTED BY THE CONSERVATION COMMISSION OR ITS AGENT.
- PREPARE WETLAND REPLICATION AREAS PER SPECIFICATIONS
- EXCAVATE WETLAND FILL AREAS AND DEPOSIT SOILS IN REPLICATION AREAS. IMPORT MATERIAL AS NEEDED. MULCH WITH STRAW TO PREVENT DRYING OUT OF SOILS.
- CONSTRUCT WETLAND REPLICATION AREAS AND PROVIDE REQUIRED OVERSIGHT.
- INSTALL AND GRADE RAIL TRAIL
- GRADE AND STABILIZE SIDE SLOPES.
- PERFORM SITE CLEAN UP AND REMOVAL OF DEBRIS.
- INSPECT SITE FOR COMPLIANCE TO PLAN SPECIFICATIONS.

RESOURCE AREA ALTERATION:

PROPOSED WETLAND ALTERATION = 1,900 SF
 PROPOSED WETLAND REPLICATION = 2,000 SF

PREPARED BY:

DUCHARME & DILLIS
 Civil Design Group, Inc.
 CIVIL ENGINEERS • LAND SURVEYORS • WETLAND CONSULTANTS
 1092 MAIN STREET, P.O. BOX 428 BOLTON, MASSACHUSETTS 01740
 PHONE: (978) 779-6091 FAX: (978) 779-0260
 www.DucharmeandDillis.com

OWNER:
 APPLICANT:
 SQUANNACOOK GREENWAYS

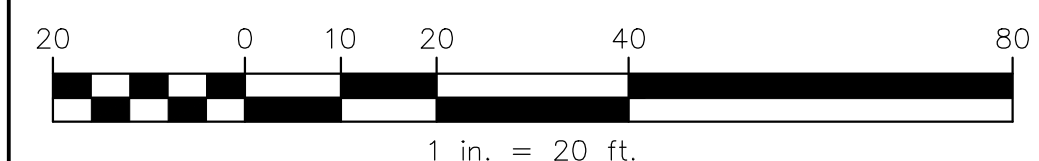
SCALE:

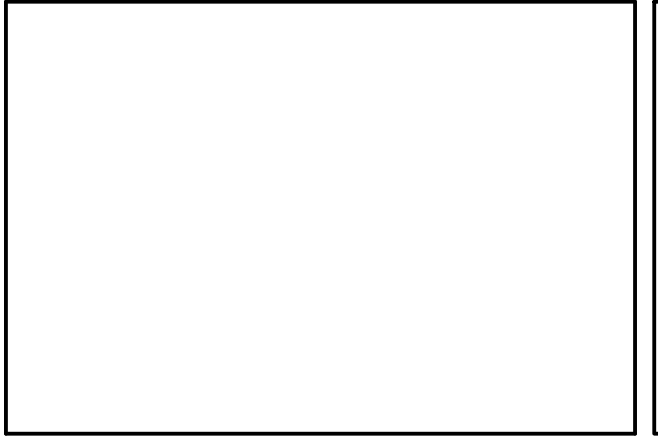
 1 in. = 20 ft.
 COPYRIGHT DUCHARME & DILLIS CIVIL DESIGN GROUP, INC 2019



DATE: 7/4/19
 DESIGN BY:
 DRAWN BY: PJP
 CHECKED BY: SRD

MITIGATION PLAN
SQUANNACOOK GREENWAYS
 TOWNSEND, MA

NO.	DATE	DESCRIPTION	BY

JOB NO. 6056
 DRAWING NO. 6056
 SHEET NO. **1**
 OF 1